

Restricted Friction Hinge

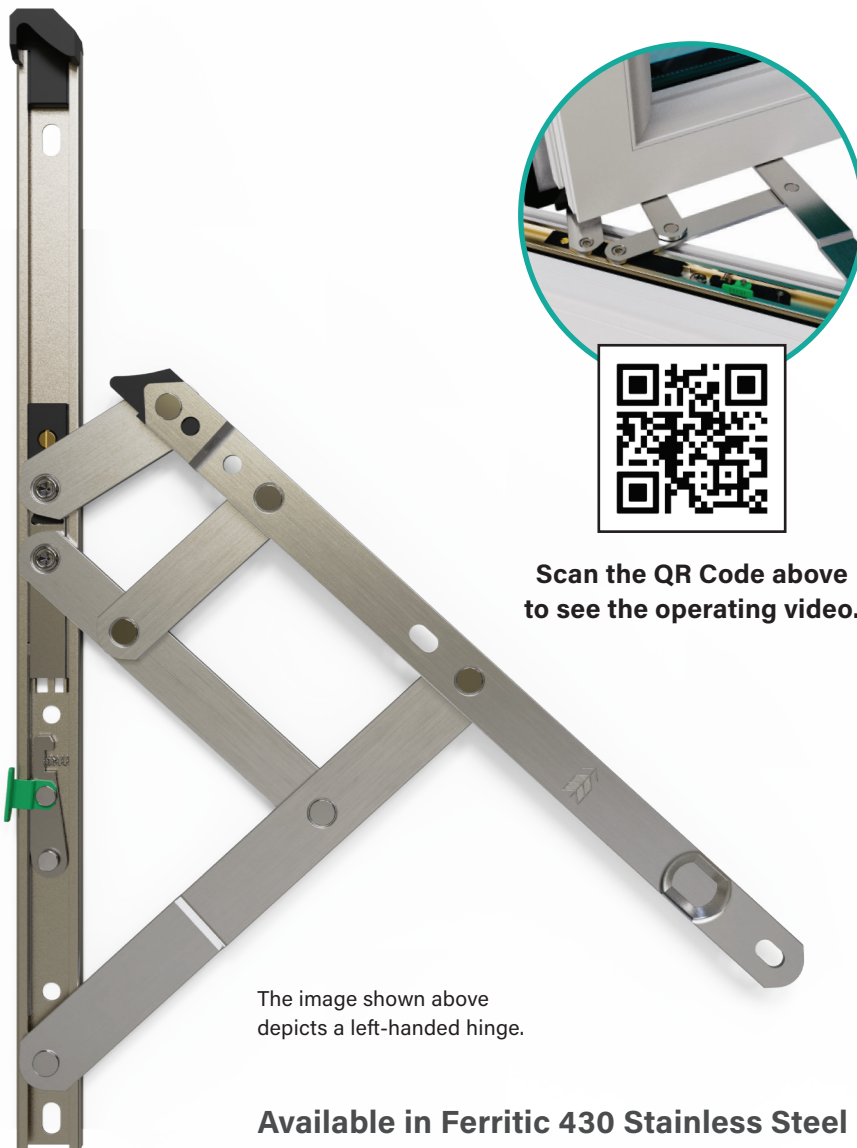

Features

- Available in both top and side hung variants.
- Geometries designed and tested to 'self-balance' open out casement windows.
- Excellent weather sealing and draught proofing performance provided by enclosed end cap when tested to BS 6375-1.
- Colour coded end caps and outer packaging clearly denote and differentiate 13mm and 17mm stack heights for ease when manufacturing multiple systems.
- Colour coded quick release button allows the restriction to be over-ridden allowing the window to be fully opened.
- Restricted function automatically resets when the window is closed.

Available in Ferritic 430 Stainless Steel and Austenitic 304 Stainless Steel

Specification

- 10 or 25 year Mechanical Guarantee: 10 year Mechanical Guarantee for standard Ferritic 430 Stainless Steel and 25 year Mechanical Guarantee for Austenitic 304 Stainless Steel.
- Tested to 20,000 cycles as part of BS 6375-2.
- Restriction tested to BS EN 14351.
- Compliant with BS 6375-2.
- Packaging: Duration Restricted Friction hinges for **Top Hung Windows** are supplied in restricted pairs consisting of a left-hand and a right-hand Hinge*. Duration Restricted Friction hinges for **Side hung Windows** are supplied as handed pairs, consisting of one Restricted Friction hinge for bottom of the sash and a regular Duration friction hinge for the top. Handing is identified from inside the window, to which side hinges are fitted.



Technical Data

Description	Max Height	Max Width	Max Weight	Full Opening Angle	Restricted Opening Angle
12" H/D Top Hung Restricted	600mm	1200mm	28kg	49°	10°
16" H/D Top Hung Restricted	750mm	1200mm	33kg	60°	18°
20" H/D Top Hung Restricted	900mm	1200mm	45kg	42°	8°
24" H/D Top Hung Restricted	1200mm	1200mm	55kg	39°	7°
12" H/D Right Hand Restricted	1200mm	600mm	24kg	49°	10°
12" H/D Left Hand Restricted	1200mm	600mm	24kg	49°	10°
16" H/D Right Hand Restricted	1200mm	650mm	28kg	60°	18°
16" H/D Left Hand Restricted	1200mm	650mm	28kg	60°	18°

* User may choose to break down pairs and use one Restricted Hinge with corresponding regular Duration Friction hinge which have the same geometry.



Scan for more information.

